

**BOUDINOT AVENUE STREET REHABILITATION
CITY OF CINCINNATI
DEPARTMENT OF TRANSPORTATION AND ENGINEERING
APRIL 19, 2016**

- Boudinot Avenue from Glenway Avenue to the corporation line near Westwood Northern Boulevard is part of DOTE's Street Rehabilitation Program this construction season. The Street Rehabilitation Program includes grinding the existing asphalt surface, performing full-depth pavement repairs and curb replacement where necessary, and placing a new asphalt pavement surface. New highly-visible thermoplastic line striping and raised pavement markers with reflectors will be applied to the new asphalt pavement.
- DOTE received a request to alleviate traffic congestion on Boudinot from Glenway to Queen City. The current line striping on Boudinot provides one 22' lane in each direction with on-street parking permitted on both sides of the street.
- DOTE staff recommends painting a center two-way left-turn lane in this area to improve traffic flow. The new layout would be one 17.5' travel and on-street parking lane in each direction with a 9' center two-way left-turn lane. On-street parking would still be permitted on both sides of the street. The turn lane will also provide a refuge area for pedestrians crossing the street. There will be no adverse effect on vehicle capacity or the number of on-street parking spaces in this section.
- DOTE also received a request from the Hamilton County Engineer's Office to extend the northbound left-turn lane on Boudinot at Westwood Northern Boulevard. Currently there is a short left-turn lane contained entirely in Green Township between the corporation line and the intersection. Many northbound vehicles on Boudinot turn left on Westwood Northern, especially during the afternoon rush-hour.
- DOTE staff recommends extending the northbound left-turn lane into the City to create one 12' southbound travel lane, a 10' northbound left-turn lane, and an 18' northbound travel lane with on-street parking permitted on the east side of the street. This configuration would result in removing on-street parking in front of the daycare center and losing approximately five on-street parking spaces in front of the grassy area on the west side of the street south of the daycare center. The line striping would then transition back to the existing layout of one 20' travel lane in each direction with on-street parking permitted on both sides of the street.
- The contractor has started full-depth repairs this week. Paving is expected to begin within 60 days. Line striping will immediately follow the paving work. Therefore, it is important to contact DOTE as soon as possible with any questions or concerns. Direct any questions or comments to:

Martha Kelly, P.E.
Principal Engineer - Transportation Planning Section
(513) 352-3648
Martha.Kelly@cincinnati-oh.gov

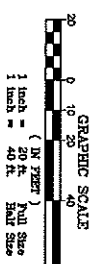
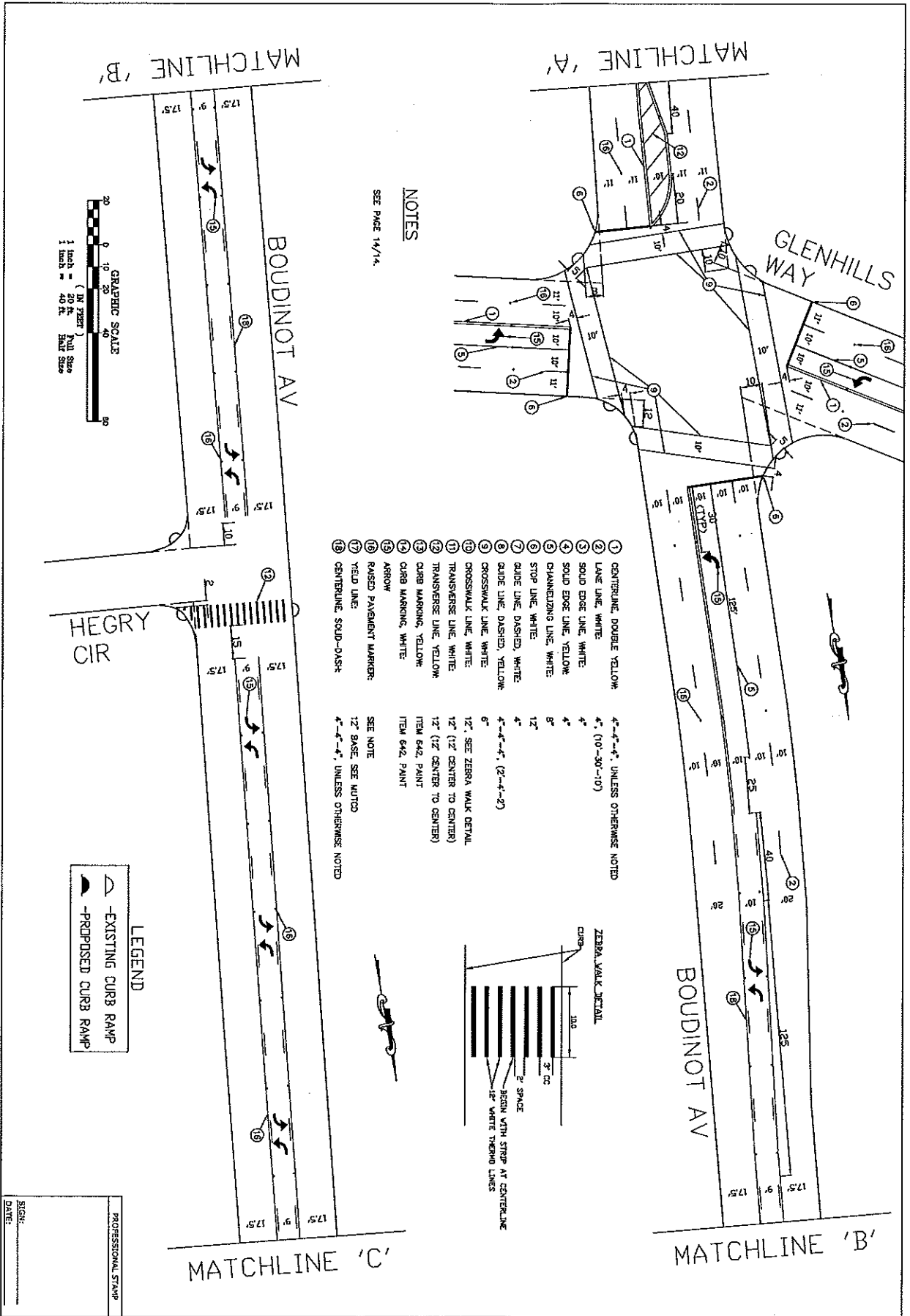

NOTES
SEE PAGE 14/14

- ① CENTERLINE, DOUBLE YELLOW 4'-4'-4' UNLESS OTHERWISE NOTED
- ② LANE LINE, WHITE 4' (10'-30'-10')
- ③ SOLID EDGE LINE, WHITE 4'
- ④ SOLID EDGE LINE, YELLOW 4'
- ⑤ CHANNELIZING LINE, WHITE 8'
- ⑥ STOP LINE, WHITE 12"
- ⑦ GUIDE LINE, DASHED, WHITE 4'
- ⑧ GUIDE LINE, DASHED, YELLOW 4'-4'-4' (2'-4'-2')
- ⑨ CROSSWALK LINE, WHITE 6'
- ⑩ CROSSWALK LINE, WHITE 12" (SEE ZEBRA WALK DETAIL)
- ⑪ TRANSVERSE LINE, WHITE 12" (1/2" CENTER TO CENTER)
- ⑫ TRANSVERSE LINE, YELLOW 12" (1/2" CENTER TO CENTER)
- ⑬ CURB MARKING, YELLOW ITEM 642, PAINT
- ⑭ CURB MARKING, WHITE ITEM 642, PAINT
- ⑮ ARROW
- ⑯ RAISED PAVEMENT MARKER
- ⑰ YIELD LINE 12" BASE, SEE NOTE
- ⑱ CENTERLINE, SOLID-DASH 4'-4'-4' UNLESS OTHERWISE NOTED

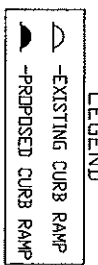
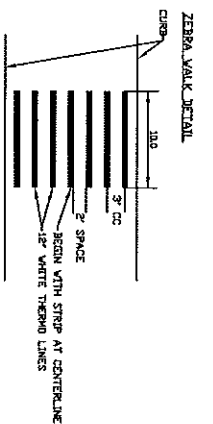

PROFESSIONAL STAMP
SIGN: _____
DATE: _____

2	14
---	----

Revisions	No.	Date

**BOUDINOT AV
Pavement Markings
GLENWAY AV - CORP LINE**

Department of Transportation and Engineering
City of Oakland
City Hall
501 Pine Street
Oakland, CA 94612

CONTRACT DRAWING
This drawing is prepared for the project identified on the title block and shall be used only for the purposes stated on the title block.



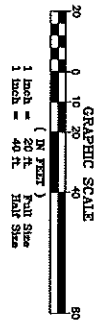
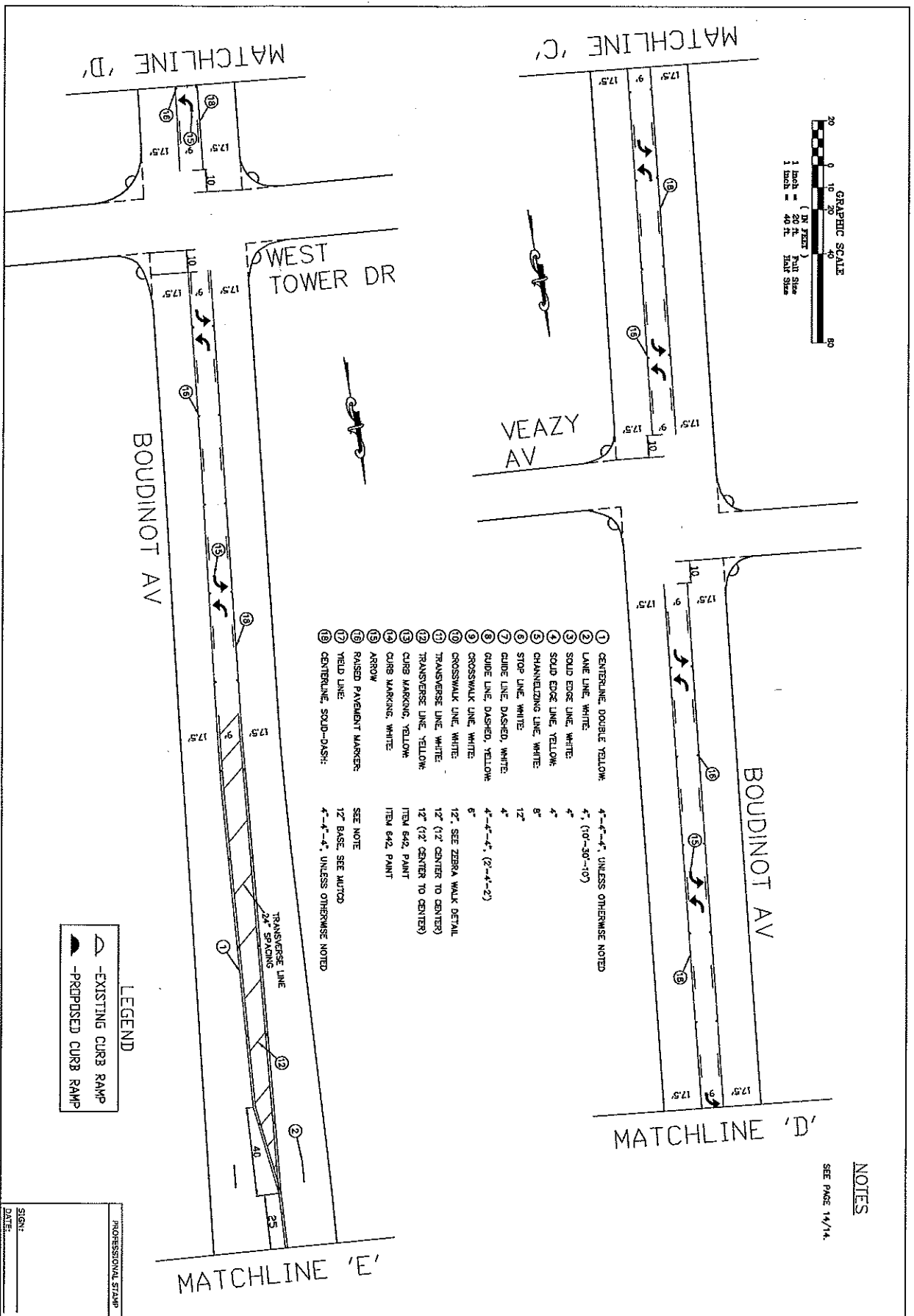

- ① CENTERLINE, DOUBLE YELLOW: 4'-4"-4', UNLESS OTHERWISE NOTED
- ② LANE LINE, WHITE: 4'
- ③ SOLID EDGE LINE, WHITE: 4', (10'-30'-10')
- ④ SOLID EDGE LINE, YELLOW: 4'
- ⑤ CHANNELIZING LINE, WHITE: 8'
- ⑥ STOP LINE, WHITE: 12"
- ⑦ GUIDE LINE, DASHED, WHITE: 4'
- ⑧ GUIDE LINE, DASHED, YELLOW: 4'-4"-4', (2'-4'-2)
- ⑨ CROSSWALK LINE, WHITE: 6"
- ⑩ CROSSWALK LINE, WHITE: 12", SEE ZEBRA WALK DETAIL
- ⑪ TRANSVERSE LINE, WHITE: 12" (1/2 CENTER TO CENTER)
- ⑫ TRANSVERSE LINE, YELLOW: 12" (1/2 CENTER TO CENTER)
- ⑬ CURB MARKING, YELLOW: ITEM 642, PAINT
- ⑭ CURB MARKING, WHITE: ITEM 642, PAINT
- ⑮ ARROW
- ⑯ RAISED PAVEMENT MARKER
- ⑰ FIELD LINE
- ⑱ CENTERLINE, SOLID-DASH:

SEE NOTE
12" BASE, SEE AUTO
4'-4"-4', UNLESS OTHERWISE NOTED

LEGEND

- EXISTING CURB RAMP
- PROPOSED CURB RAMP

PROFESSIONAL STAMP

SIGN: _____
DATE: _____

NOTES

SEE PAGE 14/14

**BOUDINOT AV
Pavement Markings
GLENWAY AV - CORP LINE**

Department of
Transportation
and Engineering

City of Detroit
2000
601 Power Street
Detroit, Michigan 48226

CONTRACT DRAWING

REVISIONS: THIS DRAWING IS THE PROPERTY OF THE CITY OF DETROIT. IT IS TO BE KEPT IN THE OFFICE OF THE CONTRACTOR FOR THE CONTRACT PURPOSES.

Drawn by	Date	Revisions
MGT		No.
MGT		
Checked by		
Reviewed by		

3
14

DATE: _____

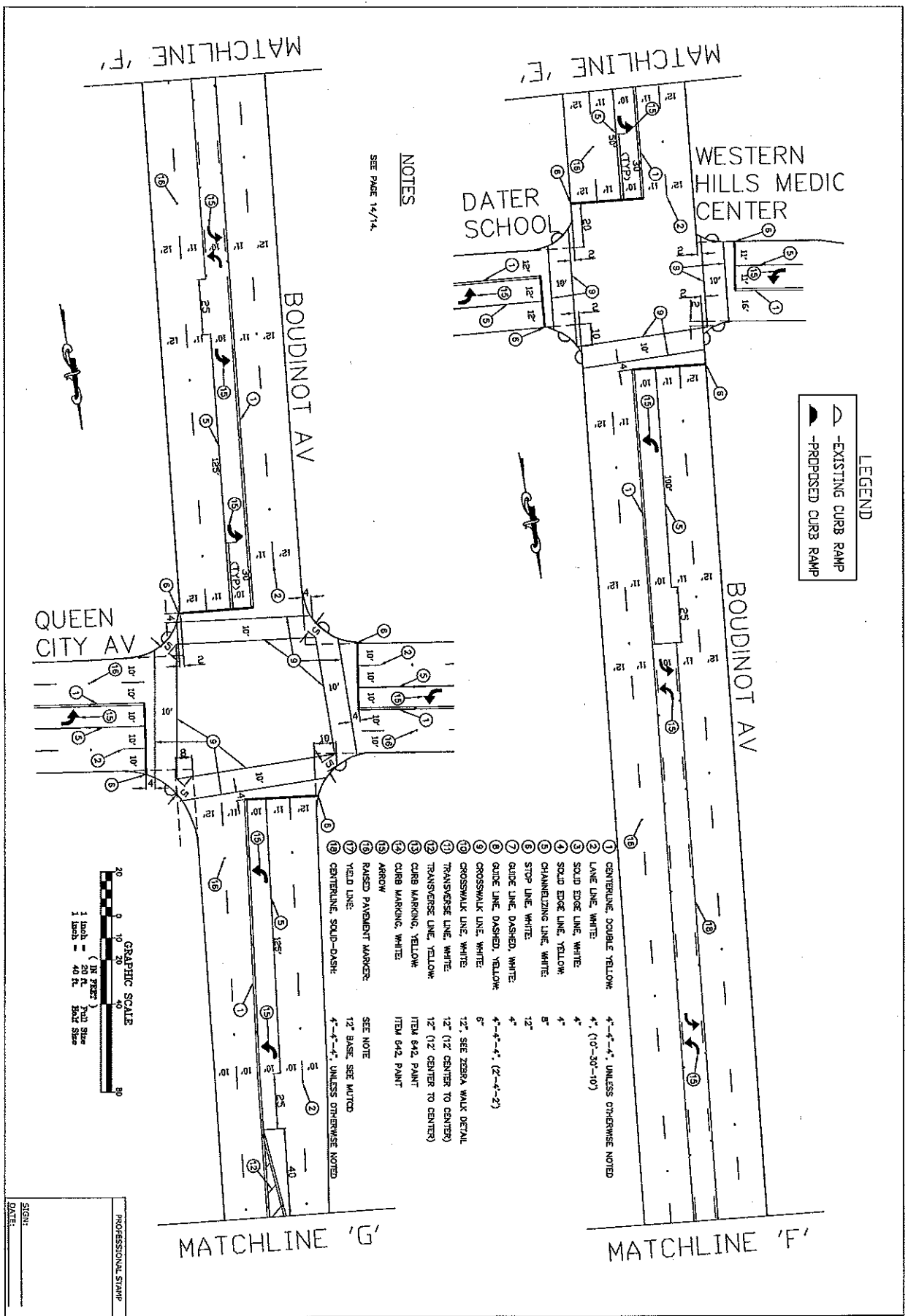

WESTERN HILLS MEDIC CENTER
 DATER SCHOOL

LEGEND
 ▽ -EXISTING CURB RAMP
 ▽ -PROPOSED CURB RAMP

NOTES
 SEE PAGE 14/14

- 1 CENTERLINE, DOUBLE YELLOW: 4'-4'-4', UNLESS OTHERWISE NOTED
- 2 LANE LINE, WHITE: 4', (10'-30'-10')
- 3 SOLID EDGE LINE, WHITE: 4'
- 4 SOLID EDGE LINE, YELLOW: 4'
- 5 CHANNELIZING LINE, WHITE: 5'
- 6 STOP LINE, WHITE: 12"
- 7 GUIDE LINE, DASHED, WHITE: 4'
- 8 GUIDE LINE, DASHED, YELLOW: 4'-4'-4', (2'-4'-2')
- 9 CROSSWALK LINE, WHITE: 5'
- 10 CROSSWALK LINE, YELLOW: 5'
- 11 TRANSVERSE LINE, WHITE: 12" (12' CENTER TO CENTER)
- 12 TRANSVERSE LINE, YELLOW: 12" (12' CENTER TO CENTER)
- 13 CURB MARKING, YELLOW: ITEM 642, PAINT
- 14 CURB MARKING, WHITE: ITEM 642, PAINT
- 15 ARROW: SEE NOTE
- 16 RAISED PAVEMENT MARKER: 12" BASE, SEE MUTCO
- 17 YIELD LINE: 4'-4'-4', UNLESS OTHERWISE NOTED
- 18 CENTERLINE, SOLID-DASH: SEE NOTE

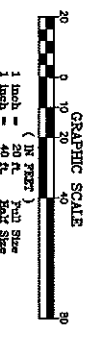

PROFESSIONAL STAMP
 SIGNATURE
 DATE

Drawn by: MGT
 Checked by: MGT
 Reviewed by: _____
 Date: _____

Revisions	No.	Date

Department of Transportation and Engineering
 City of Cleveland
 2011-12-15
 2011-12-15
 12-15-11, 12-15-11

BOUDINOT AV
 Pavement Markings
 GLENWAY AV - CORP LINE

CONTRACT DRAWING
 THIS DRAWING IS THE PROPERTY OF THE CITY OF CLEVELAND. IT IS TO BE KEPT IN THE OFFICE OF THE ENGINEER AND NOT TO BE REPRODUCED OR COPIED FOR ANY OTHER PURPOSES.

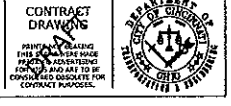

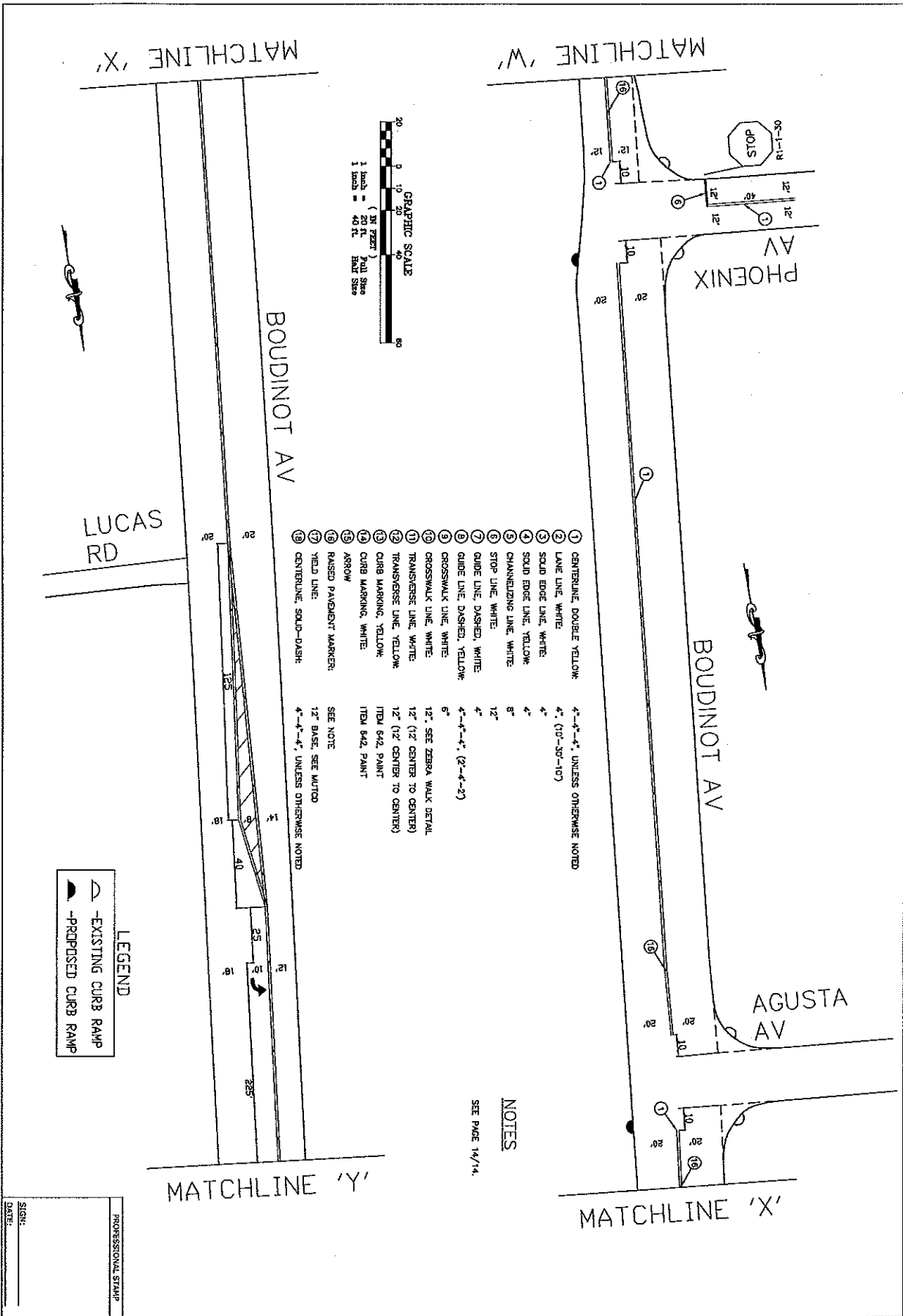

MATCHLINE 'W'

MATCHLINE 'X'

PHOENIX AV

BOUDINOT AV

AGUSTA AV

BOUDINOT AV

LUCAS RD

MATCHLINE 'Y'

MATCHLINE 'X'

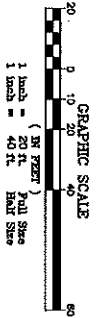

- ① CENTERLINE, DOUBLE YELLOW 4'-6"-4', UNLESS OTHERWISE NOTED
- ② LANE LINE, WHITE 4', (10'-30'-10')
- ③ SOLID EDGE LINE, WHITE 4'
- ④ SOLID EDGE LINE, YELLOW 4'
- ⑤ CHANNELIZING LINE, WHITE 8'
- ⑥ STOP LINE, WHITE 12'
- ⑦ GUIDE LINE, DASHED, WHITE 4'-4'-4', (2'-4'-2')
- ⑧ CROSSWALK LINE, WHITE 6'
- ⑨ TRANSVERSE LINE, WHITE 12" (1/2 CENTER TO CENTER)
- ⑩ CURB MARKING, YELLOW 12" (1/2 CENTER TO CENTER)
- ⑪ CURB MARKING, WHITE ITDA 642, PAINT
- ⑫ RASPED PAVEMENT MARKER: SEE NOTE
- ⑬ YIELD LINE: 12' BASE, SEE M.I.T.O.D.
- ⑭ CENTRLINE, SOLID-DASH: 4'-4'-4', UNLESS OTHERWISE NOTED

NOTES

SEE PAGE 14/14.

LEGEND

- EXISTING CURB RAMP
- PROPOSED CURB RAMP

PROFESSIONAL STAMP

SIGNATURE: _____

DATE: _____

Drawn by: _____ Date: _____

Checked by: _____ Date: _____

Reviewed by: _____ Date: _____

Consultant: _____

Revisions	No.	Date

BOUDINOT AV
Pavement Markings
GLENWAY AV - CORP LINE

Department of Transportation and Engineering
City of Grand Rapids
221 Park Street
Grand Rapids, MI 49503

CONTRACT DRAWING

THIS DRAWING IS THE PROPERTY OF THE CITY OF GRAND RAPIDS AND IS TO BE KEPT IN THE OFFICE OF THE CONTRACTOR.



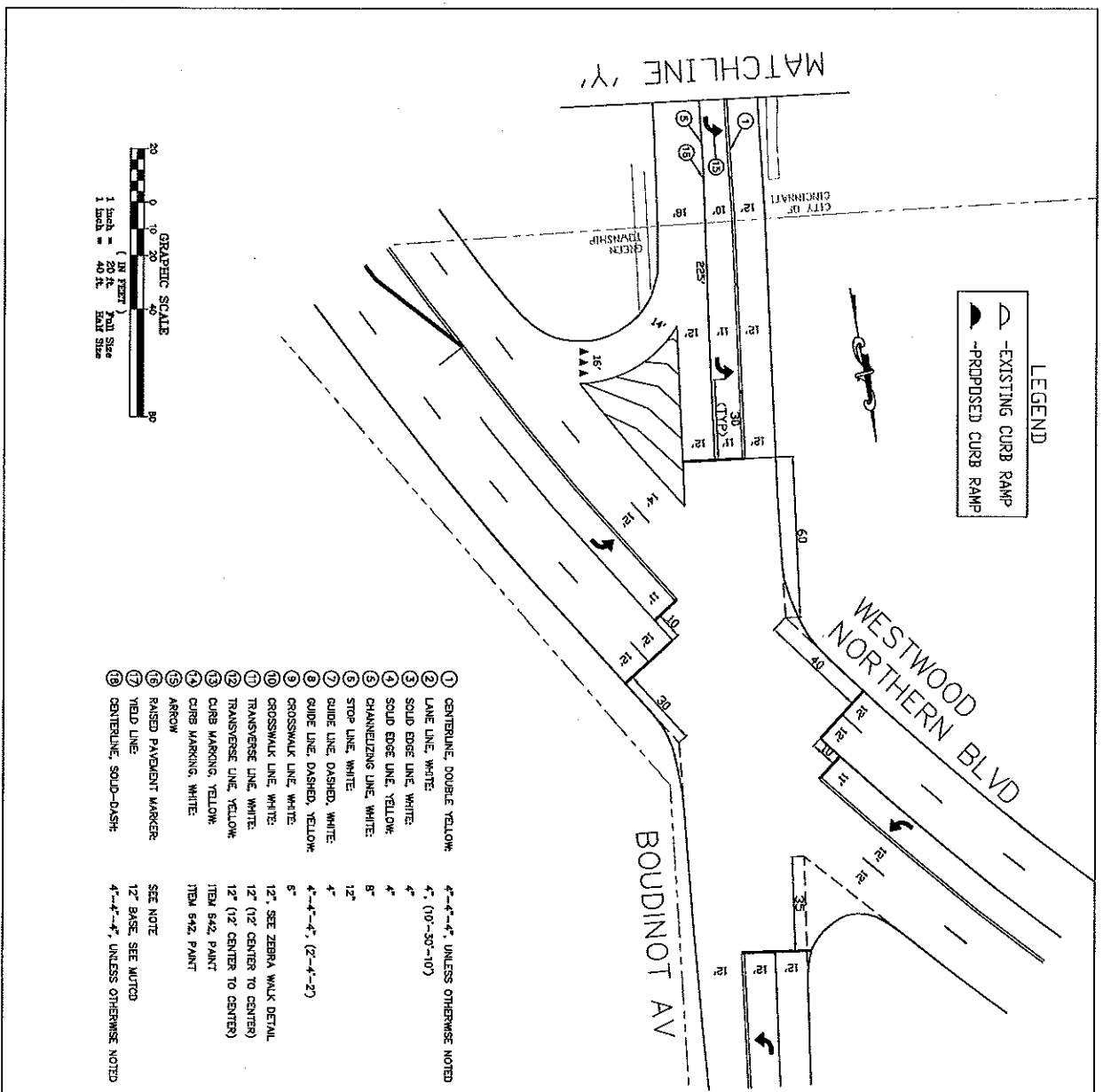

LEGEND

▲ - EXISTING CURB RAMP

▴ - PROPOSED CURB RAMP

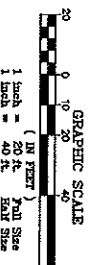

- ① CENTERLINE, DOUBLE YELLOW
- ② LANE LINE, WHITE
- ③ SOLID EDGE LINE, WHITE
- ④ SOLID EDGE LINE, YELLOW
- ⑤ CHANNELIZING LINE, WHITE
- ⑥ STOP LINE, WHITE
- ⑦ GUIDE LINE, DASHED, WHITE
- ⑧ GUIDE LINE, DASHED, YELLOW
- ⑨ CROSSWALK LINE, WHITE
- ⑩ CROSSWALK LINE, WHITE
- ⑪ TRANSVERSE LINE, WHITE
- ⑫ TRANSVERSE LINE, YELLOW
- ⑬ CURB MARKING, YELLOW
- ⑭ CURB MARKING, WHITE
- ⑮ ARROW
- ⑯ RAISED PAVEMENT MARKER
- ⑰ YIELD LINE
- ⑱ CENTERLINE, SOLID-DASH

- ① 4"-4"-4" UNLESS OTHERWISE NOTED
- ② 4", (10'-30'-10')
- ③ 4"
- ④ 4"
- ⑤ 8"
- ⑥ 12"
- ⑦ 4"
- ⑧ 4"-4"-4", (2'-4'-2')
- ⑨ 5"
- ⑩ 12", SEE ZEBRA WALK DETAIL
- ⑪ 12" (1/2" CENTER TO CENTER)
- ⑫ 12" (1/2" CENTER TO CENTER)
- ⑬ ITEM 542, PAINT
- ⑭ ITEM 542, PAINT
- ⑮ SEE NOTE
- ⑯ 12" BASE, SEE NOTE
- ⑰ 4"-4"-4", UNLESS OTHERWISE NOTED
- ⑱ UNLESS OTHERWISE NOTED

NOTES

- 1) LAYOUT THE LOCATIONS OF ALL PAVEMENT MARKINGS ON THE INTERMEDIATE AND SURFACE COURSES PRIOR TO INSTALLATION TO ASSURE THEIR PROPER PLACEMENT. CONTACT THE CONSTRUCTION ENGINEER TO SCHEDULE APPROVAL OF THE PAVEMENT MARKING LAYOUT.
- 2) REMOVE ALL EXISTING MARKINGS THAT CONFLICT WITH THE FINAL PAVEMENT MARKINGS USING THE METHODS DESCRIBED IN SECTION 614.11 OF THE MOST RECENT ODOT OMS MANUAL, OR BY OTHER METHODS WITH PRIOR APPROVAL OF THE CONSTRUCTION ENGINEER. THE COST FOR THIS WORK IS INCIDENTAL TO THE COST OF THE NEW PAVEMENT MARKINGS.
- 3) APPLY ITEM 542 CLASS 1 PAINT WITH GLASS BEADS (FULL PATTERN) TEMPORARY PAVEMENT MARKINGS PER THE FINAL PAVEMENT MARKING PLANS IMMEDIATELY UPON COMPLETION OF THE PAVEMENT MILLING, INTERMEDIATE COURSE, AND SURFACE COURSE.
- 4) LOOP DETECTOR WORK WILL TAKE PLACE AFTER FINISH TEMPORARY PAVEMENT MARKINGS ON THE SURFACE COURSE. PLACE FINAL TEMPORARY PAVEMENT MARKINGS ON THE SURFACE COURSE AFTER COMPLETING LOOP DETECTOR WORK.
- 5) USE THERMOPLASTIC MATERIAL MEETING THE REQUIREMENTS OF ITEM 544 OF THE MOST RECENT ODOT OMS MANUAL, UNLESS OTHERWISE NOTED FOR FINAL PAVEMENT MARKINGS ON THE SURFACE COURSE.
- 6) DO NOT PLACE BIKE SYMBOLS AND SHARROWS IN FRONT OF DRIVEWAYS. IF THERE IS A CONFLICT, OBTAIN THE ENGINEER'S APPROVAL PRIOR TO INSTALLATION.
- 7) PROPOSED CURB RAMP TYPES AND EXACT LOCATIONS WILL BE DETERMINED IN THE FIELD.
- 8) RAISED PAVEMENT MARKERS: PLACE TWO-SIDED (WHITE/RED) RAISED PAVEMENT MARKERS ALONG ALL LANE LINES AT 80' INTERVALS UNLESS OTHERWISE NOTED. PLACE TWO-SIDED (YELLOW/YELLOW) RAISED PAVEMENT MARKERS ALL ALL DOUBLE YELLOW CENTERLINES AT 40' INTERVALS UNLESS OTHERWISE NOTED.
- 9) PLACE TWO-SIDED (WHITE/RED) RAISED PAVEMENT MARKERS ALONG CHANNELIZING LINES AND WHITE EDGE LINES AT 40' INTERVALS UNLESS OTHERWISE NOTED.
- 10) PLACE TWO-SIDED (BLUE/BLUE) RAISED PAVEMENT MARKERS ON THE CENTERLINE, NEAR-SIDE LANE LINES, AND EDGE LINE CLOSEST TO ALL TREE INTERFACES.

PROFESSIONAL STAMP

SIGN: _____

DATE: _____

14

14

BOUDINOT AV
Pavement Markings
GLENWAY AV - CORP LINE

Department of
Transportation
and Engineering

City of Des Moines
City Hall
1000 East 10th Street
Des Moines, IA 50319

CONTRACT DRAWING

REVISIONS TO BE MADE TO THIS DRAWING SHALL BE MADE BY THE CONTRACTOR AND SHALL BE IN ACCORDANCE WITH THE CONTRACT PROVISIONS.

